



# Differential Wheel Module



## I Overview

The differential drive wheel unit is a fundamental motion solution for AGVs and AMRs, using two independently driven wheels to achieve steering through speed differential. The wheel diameter is 123.847 mm, and the motor power is 0.4 kW. The load capacity is 150 kg. The flange shape is Round (R). The company abbreviation is ATOMBOTIX.

## I Model Nomenclature

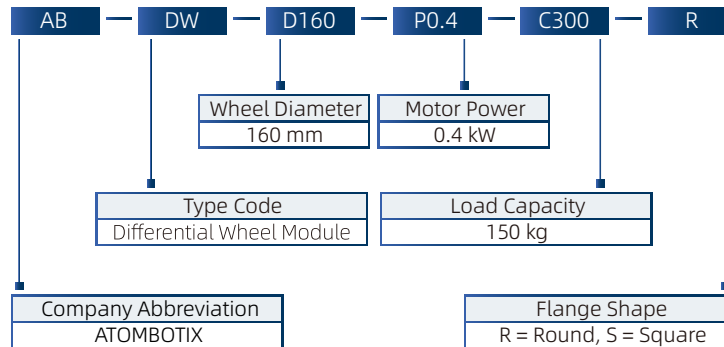

## I Key Feature



Simple control principle



Compact structure design



Cost-effective solution



Reliable performance

Differential speed control enables steering without steering additional mechanisms

Integrated drive unit allow easy installation in various vehicle configurations

Fewer mechanical components reduce complexity system overall and cost

Proven structure ensures stable operation and low maintenance requirements

## I Installation Layout

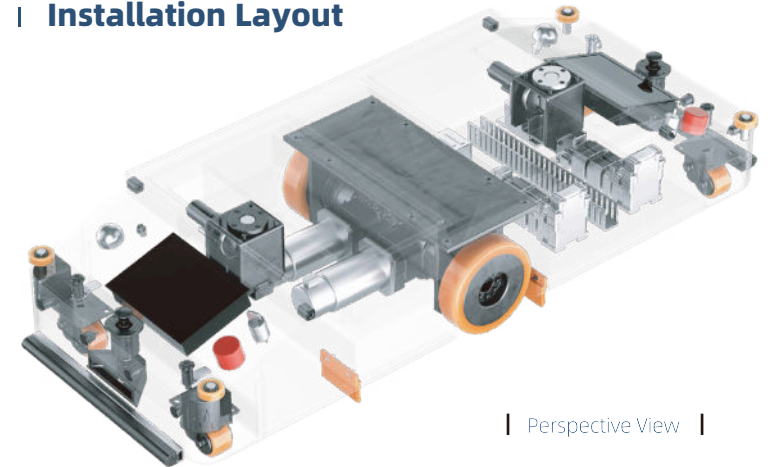

| Perspective View |

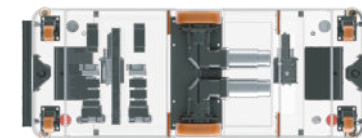

| Bottom View |



| Side View |



Basic Information	
Wheel Diameter(mm)	105
Wheel Hub Diameter(mm)	95
Wheel Material	Polyurethane      Rubber
Load Capacity(kg)	150      /
Rated Voltage(V)	48
Flange Type	Square flange
Maintenance Method	Refer to maintenance manual
Maintenance Interval	Refer to maintenance manual

Drive Unit	
Motor Model	SMC60S/0020/30MAK/5DSU
Rated Power(W)	200
Rated Speed(rpm)	3000
Rated Torque(N·m)	0.64
Rated Current(A)	10.6
Built/in Encoder Type	Incremental magnetic Encoder
Encoder Performance	/

Gearbox Unit								
Gear Ratio	16	20	25	28	35	40	50	70
Gearbox Torque(N·m)	30	30	33	30	33	30	33	21.5
Max. Speed(m/min)	61.8	49.5	39.6	35.3	28.3	24.7	19.8	14.1
Traction Force(N)	175.5	219.4	274.3	307.2	384	438.9	548.6	322.5
Towing Capacity(kg)	333.5	416.9	521.1	583.7	729.6	833.8	1042.3	612.8

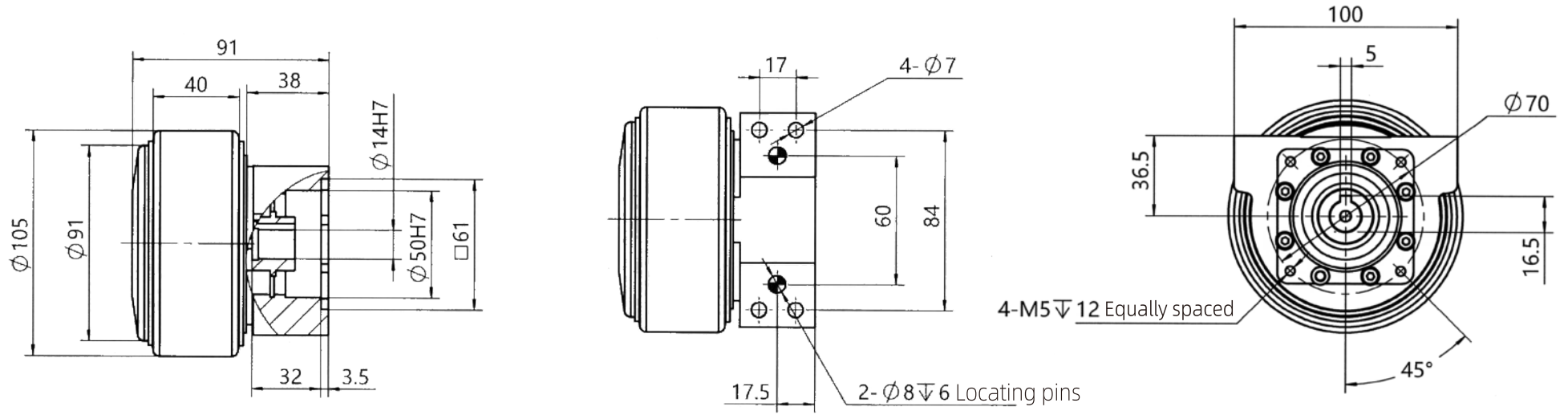

Basic Information	
Wheel Diameter(mm)	120
Wheel Hub Diameter(mm)	95
Wheel Material	Polyurethane      Rubber
Load Capacity(kg)	150      /
Rated Voltage(V)	48
Flange Type	Square flange
Maintenance Method	Refer to maintenance manual
Maintenance Interval	Refer to maintenance manual

Drive Unit	
Motor Model	SMC60S/0040/30MAK/5DSU
Rated Power(W)	400
Rated Speed(rpm)	3000
Rated Torque(N·m)	1.27
Rated Current(A)	2.8
Built/in Encoder Type	Incremental magnetic Encoder
Encoder Performance	/

Gearbox Unit								
Gear Ratio	16	20	25	28	35	40	50	70
Gearbox Torque(N·m)	30	30	33	30	33	30	33	21.5
Max. Speed(m/min)	70.7	56.5	45.2	40.4	32.3	28.3	22.6	16.1
Traction Force(N)	304.8	381	476.3	450	495	450	495	322.5
Towing Capacity(kg)	579.1	723.9	904.9	855	940.5	855	940.5	612.8

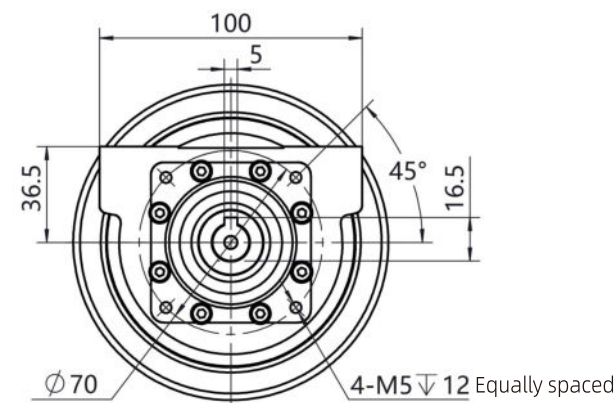
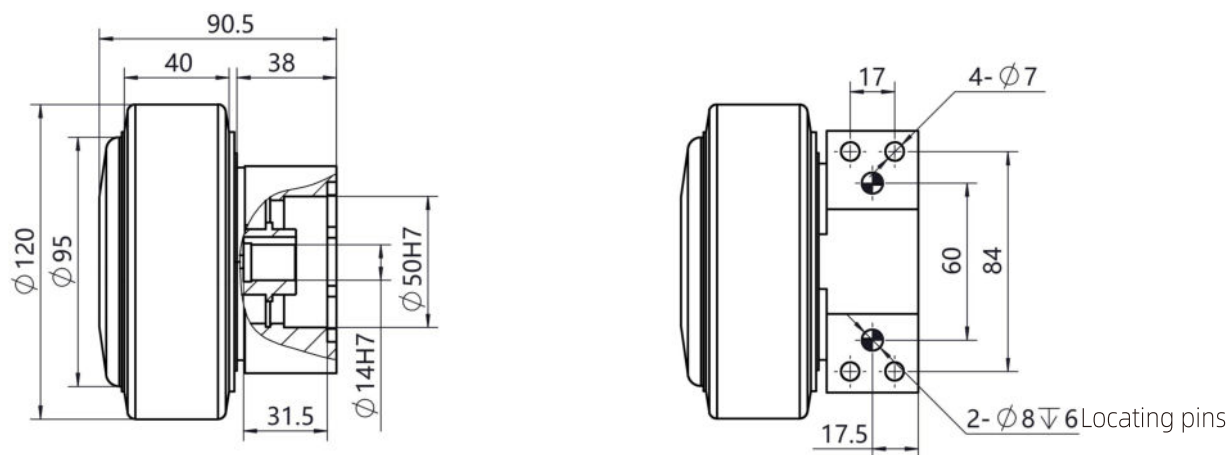

Basic Information	
Wheel Diameter(mm)	150
Wheel Hub Diameter(mm)	125
Wheel Material	Polyurethane      Rubber
Load Capacity(kg)	300      /
Rated Voltage(V)	48
Flange Type	Square flange
Maintenance Method	Refer to maintenance manual
Maintenance Interval	Refer to maintenance manual

Drive Unit	
Motor Model	SMC80S/0075/30MAK/5DSU
Rated Power(W)	750
Rated Speed(rpm)	3000
Rated Torque(N·m)	2.39
Rated Current(A)	19
Built/in Encoder Type	Incremental magnetic Encoder
Encoder Performance	/

Gearbox Unit								
Gear Ratio	16	20	25	28	35	40	50	70
Gearbox Torque(N·m)	96	96	105	96	105	96	105	71.5
Max. Speed(m/min)	88.3	70.7	56.5	50.5	40.4	35.3	28.3	20.2
Traction Force(N)	458.9	573.6	717	803	1003.8	1147.2	1260	858
Towing Capacity(kg)	871.9	1090	1362.3	1525.8	1907.2	2179.7	2394	1630.2

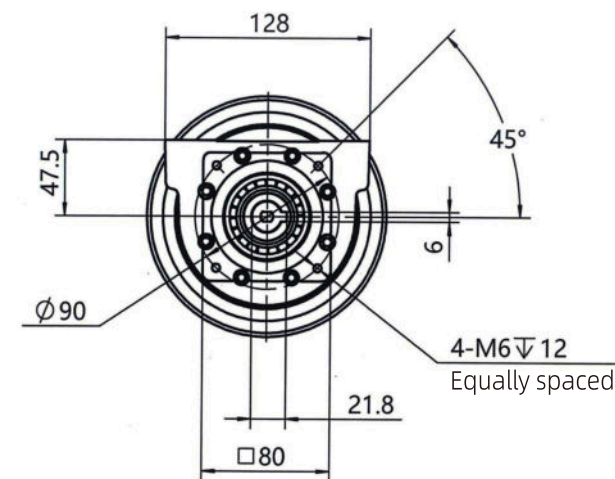
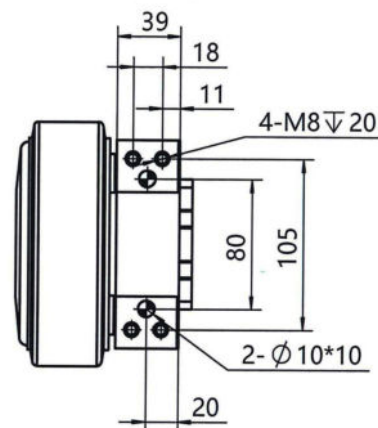
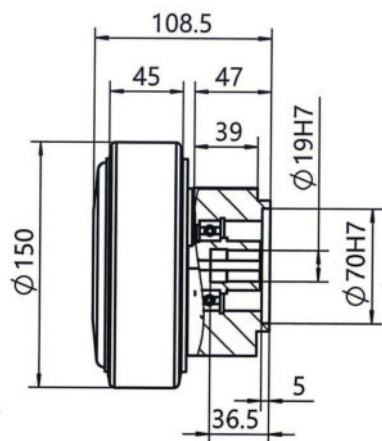

Basic Information	
Wheel Diameter(mm)	160
Wheel Hub Diameter(mm)	125
Wheel Material	Polyurethane      Rubber
Load Capacity(kg)	350      /
Rated Voltage(V)	48
Flange Type	Square flange
Maintenance Method	Refer to maintenance manual
Maintenance Interval	Refer to maintenance manual

Drive Unit	
Motor Model	SMC80S/0075/30MAK/5DSU
Rated Power(W)	750
Rated Speed(rpm)	3000
Rated Torque(N·m)	2.39
Rated Current(A)	22.4
Built/in Encoder Type	Incremental magnetic Encoder
Encoder Performance	/

Gearbox Unit								
Gear Ratio	16	20	25	28	35	40	50	70
Gearbox Torque(N·m)	96	96	105	96	105	96	105	71.5
Max. Speed(m/min)	94.2	75.4	60.3	53.8	43.1	37.7	30.1	21.5
Traction Force(N)	430.2	537.8	672.2	752.9	941.1	1075.5	1181	804.4
Towing Capacity(kg)	817.4	1022	1277.2	1430.4	1788	2043.5	2244	1528.3

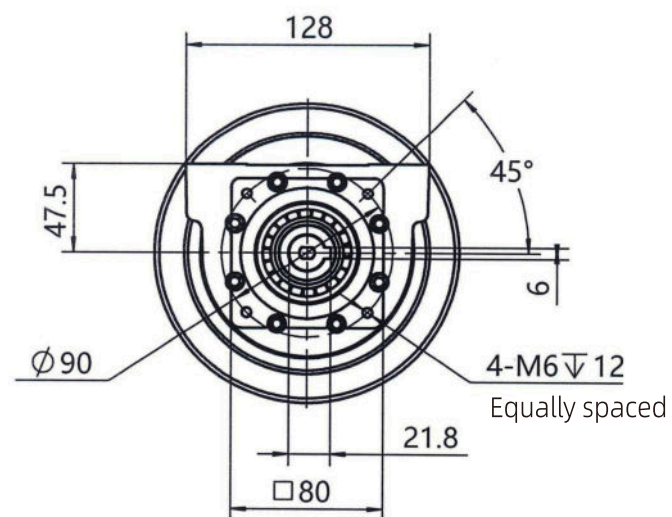
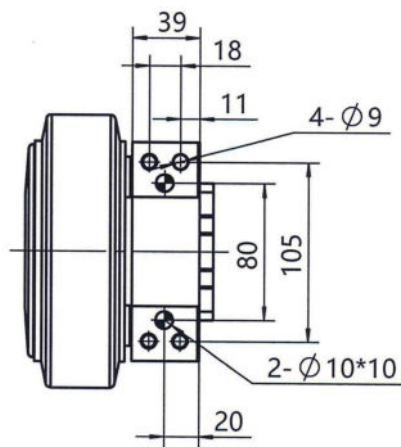
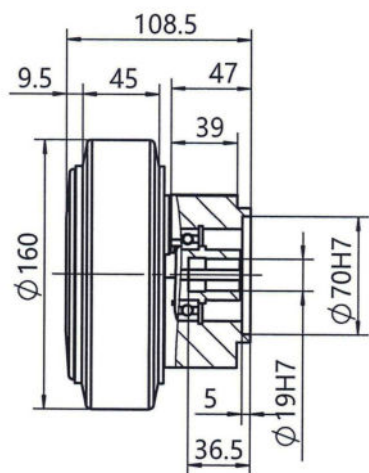
**AB-DW-D160-P0.75-C350-S**
**NO. 4**

Basic Information		Drive Unit	
Wheel Diameter(mm)	180	Motor Model	SMC80S/0100/30MAK/5DSU
Wheel Hub Diameter(mm)	150	Rated Power(W)	1000
Wheel Material	Polyurethane      Rubber	Rated Speed(rpm)	3000
Load Capacity(kg)	450      /	Rated Torque(N·m)	3.2
Rated Voltage(V)	48	Rated Current(A)	26
Flange Type	Square flange	Built/in Encoder Type	Incremental magnetic Encoder
Maintenance Method	Refer to maintenance manual	Encoder Performance	/
Maintenance Interval	Refer to maintenance manual		

Gearbox Unit								
Gear Ratio	16	20	25	28	35	40	50	70
Gearbox Torque(N·m)	96	96	105	96	105	96	105	71.5
Max. Speed(m/min)	106	84.8	67.8	60.6	48.4	42.4	33.9	24.2
Traction Force(N)	512	640	800	896	1050	960	1050	715
Towing Capacity(kg)	972	1216	1520	1702	1995	1824	1995	1358.5

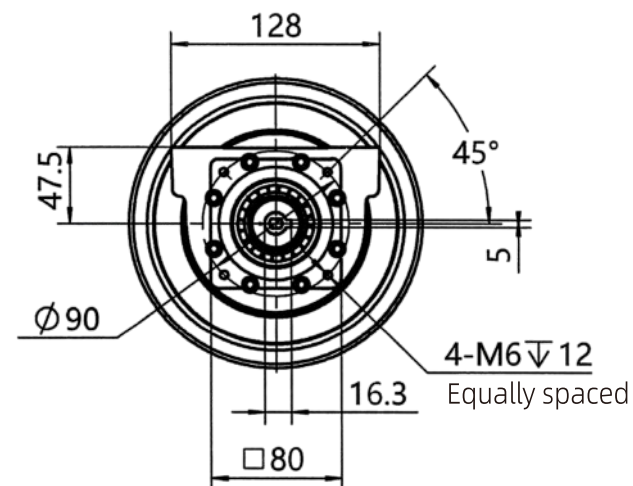
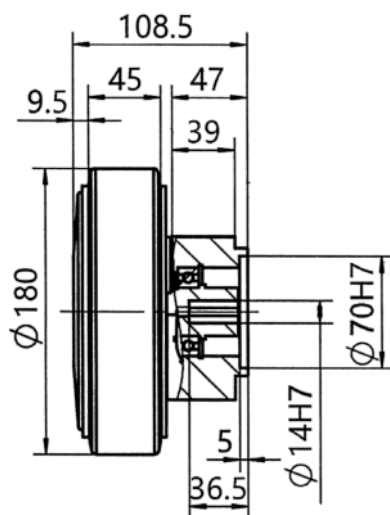
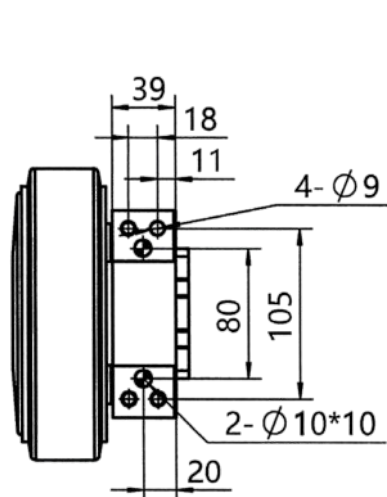

Basic Information	
Wheel Diameter(mm)	200
Wheel Hub Diameter(mm)	150
Wheel Material	Polyurethane      Rubber
Load Capacity(kg)	450      /
Rated Voltage(V)	48
Flange Type	Square flange
Maintenance Method	Refer to maintenance manual
Maintenance Interval	Refer to maintenance manual

Drive Unit	
Motor Model	SMC60S/0040/30MAK/5DSU
Rated Power(W)	400
Rated Speed(rpm)	3000
Rated Torque(N·m)	1.27
Rated Current(A)	11.95
Built/in Encoder Type	Incremental magnetic Encoder
Encoder Performance	/

Gearbox Unit								
Gear Ratio	16	20	25	28	35	40	50	70
Gearbox Torque(N·m)	30	30	33	30	33	30	33	21.5
Max. Speed(m/min)	117.8	94.2	75.4	67.3	53.8	47.1	37.7	26.9
Traction Force(N)	180	220	280	270	290	270	290	190
Towing Capacity(kg)	340	410	530	510	550	510	550	360

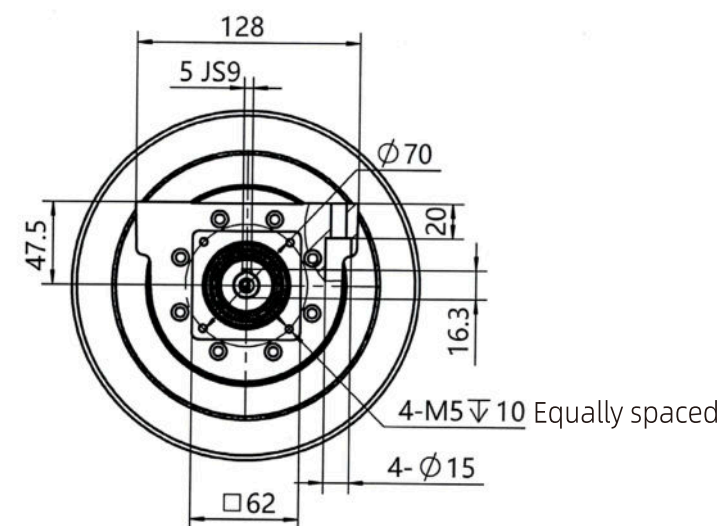
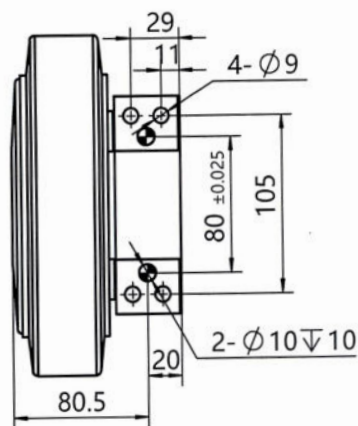
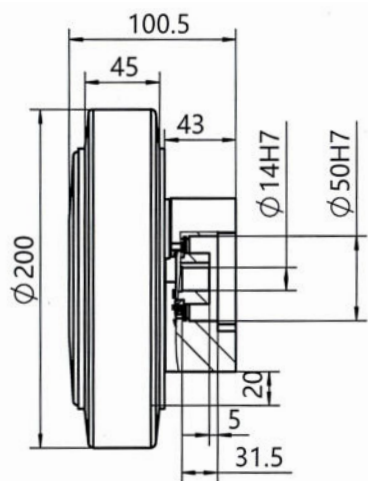

Basic Information	
Wheel Diameter(mm)	200
Wheel Hub Diameter(mm)	150
Wheel Material	Polyurethane      Rubber
Load Capacity(kg)	450      /
Rated Voltage(V)	48
Flange Type	Square flange
Maintenance Method	Refer to maintenance manual
Maintenance Interval	Refer to maintenance manual

Drive Unit	
Motor Model	SMC80S/0075/30MAK/5DSU
Rated Power(W)	750
Rated Speed(rpm)	3000
Rated Torque(N·m)	2.39
Rated Current(A)	22.4
Built/in Encoder Type	Incremental magnetic Encoder
Encoder Performance	/

Gearbox Unit								
Gear Ratio	16	20	25	28	35	40	50	70
Gearbox Torque(N·m)	96	96	105	96	105	96	105	71.5
Max. Speed(m/min)	117.8	94.2	75.4	67.3	53.8	47.1	37.7	26.9
Traction Force(N)	344.2	430.2	537.8	602.3	752.9	860.4	945	643.5
Towing Capacity(kg)	653.9	817.4	1021.7	1144.3	1430.4	1634.8	1795	1222.7

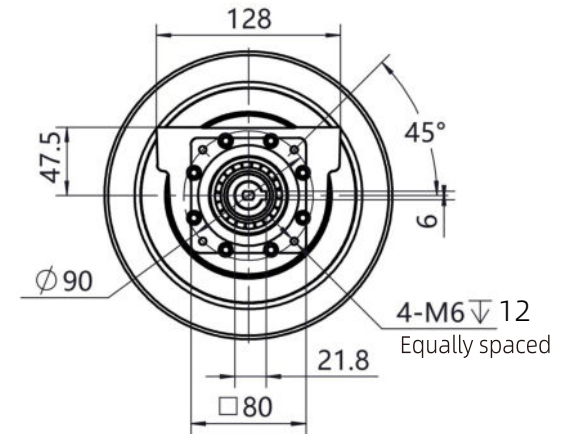
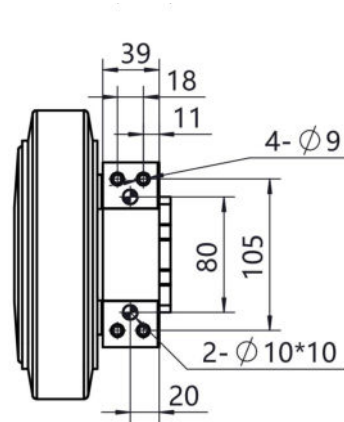
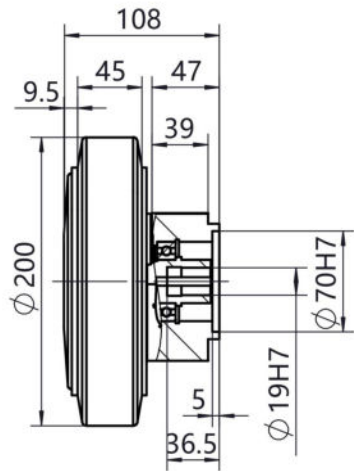

Basic Information	
Wheel Diameter(mm)	220
Wheel Hub Diameter(mm)	165
Wheel Material	Polyurethane      Rubber
Load Capacity(kg)	1120      700
Rated Voltage(V)	48
Flange Type	Square flange
Maintenance Method	Refer to maintenance manual
Maintenance Interval	Refer to maintenance manual

Drive Unit	
Motor Model	SMC130S/0150/30MAK/5DSU
Rated Power(W)	1500
Rated Speed(rpm)	3000
Rated Torque(N·m)	4.77
Rated Current(A)	39
Built/in Encoder Type	Incremental magnetic Encoder
Encoder Performance	/

Gearbox Unit								
Gear Ratio	16	20	25	28	35	40	50	70
Gearbox Torque(N·m)	250	250	264	250	264	250	264	177
Max. Speed(m/min)	129.5	103.6	82.9	74	59.2	51.8	41.4	26.9
Traction Force(N)	624.4	780.5	975.7	1092.8	1366	1561.1	1951.4	1448.2
Towing Capacity(kg)	1186.4	1483	1853.8	2076.3	2595.3	2966.1	3707.6	2751.5

\* Wheel material: Polyurethane (PU) standard, Rubber (RB) optional

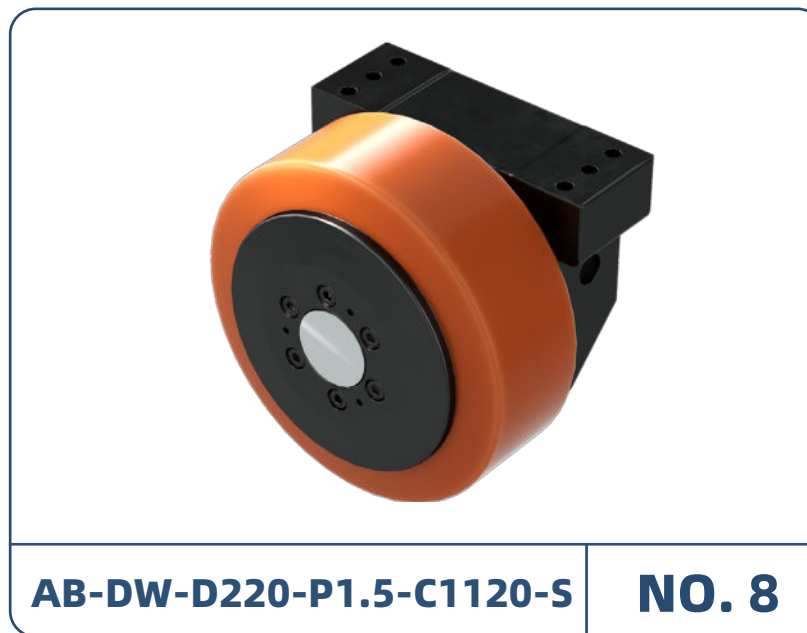
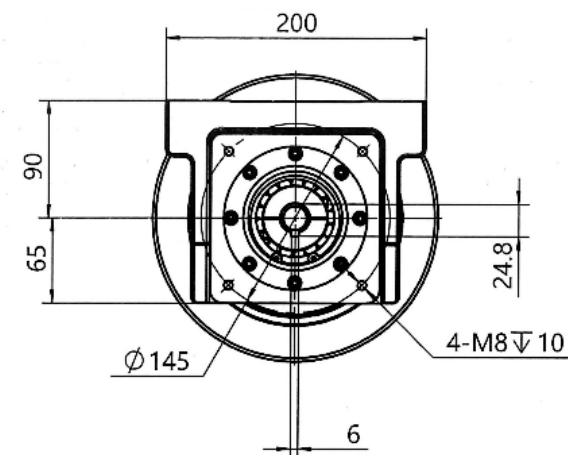
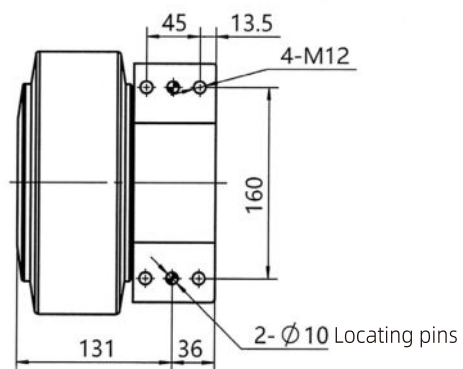
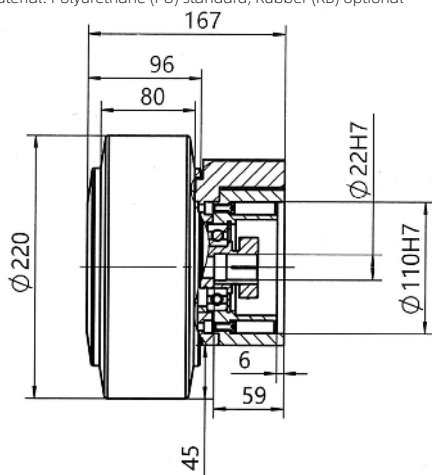

**AB-DW-D220-P1.5-C1120-S**

**NO. 8**



Basic Information	
Wheel Diameter(mm)	250
Wheel Hub Diameter(mm)	165
Wheel Material	Polyurethane      Rubber
Load Capacity(kg)	1120      /
Rated Voltage(V)	48
Flange Type	Square flange
Maintenance Method	Refer to maintenance manual
Maintenance Interval	Refer to maintenance manual

Drive Unit	
Motor Model	SMC130S/0150/30MAK/5DSU
Rated Power(W)	1500
Rated Speed(rpm)	3000
Rated Torque(N·m)	4.77
Rated Current(A)	39
Built/in Encoder Type	Incremental magnetic Encoder
Encoder Performance	/

Gearbox Unit								
Gear Ratio	16	20	25	28	35	40	50	70
Gearbox Torque(N·m)	250	250	264	250	264	250	264	177
Max. Speed(m/min)	147.2	117.8	94.2	84.1	67.3	58.9	47.1	33.6
Traction Force(N)	549	686	858	961	1202	1373	1717	1274
Towing Capacity(kg)	1044	1305	1631	1827	2283	2610	3262	2421

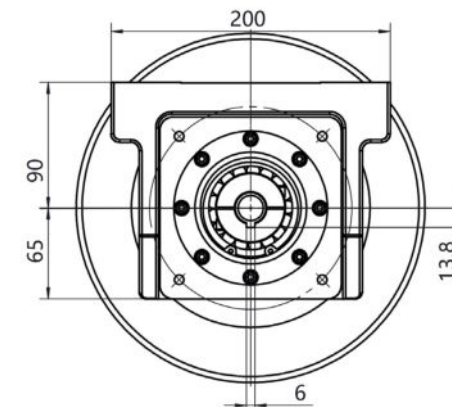
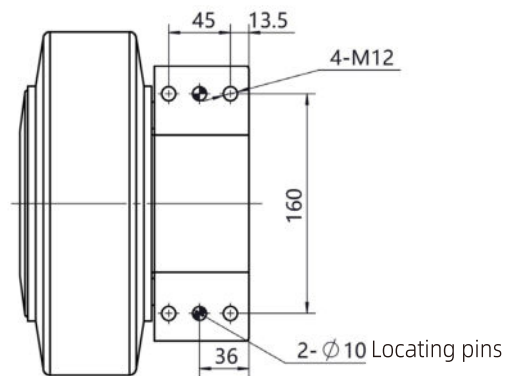
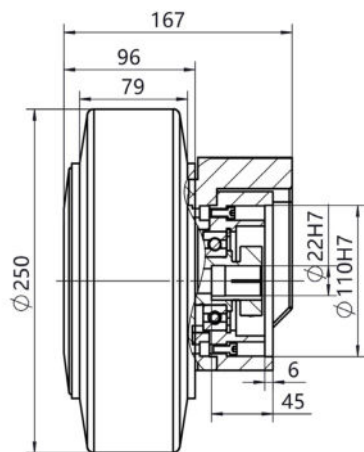

Basic Information	
Wheel Diameter(mm)	105
Wheel Hub Diameter(mm)	95
Wheel Material	Polyurethane      Rubber
Load Capacity(kg)	150      /
Rated Voltage(V)	48
Flange Type	Round flange
Maintenance Method	Refer to maintenance manual
Maintenance Interval	Refer to maintenance manual

Drive Unit	
Motor Model	SMC60S/0020/30MAK/5DSU
Rated Power(W)	200
Rated Speed(rpm)	3000
Rated Torque(N·m)	0.64
Rated Current(A)	10.6
Built/in Encoder Type	Incremental magnetic Encoder
Encoder Performance	/

Gearbox Unit								
Gear Ratio	16	20	25	28	35	40	50	70
Gearbox Torque(N·m)	30	30	33	30	33	30	33	21.5
Max. Speed(m/min)	61.8	49.5	39.6	35.3	28.3	24.7	19.8	14.1
Traction Force(N)	175.5	219.4	274.3	307.2	384	438.9	548.6	322.5
Towing Capacity(kg)	333.5	416.9	521.1	583.7	729.6	833.8	1042.3	612.8



**AB-DW-D105-P0.2-C150-R**

**NO. 10**

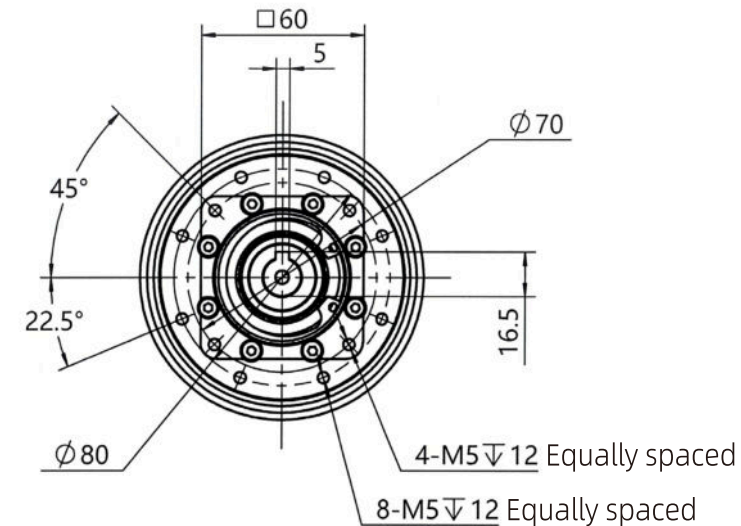
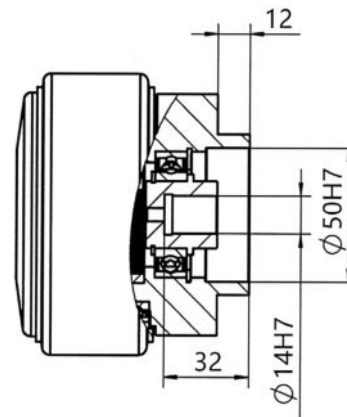
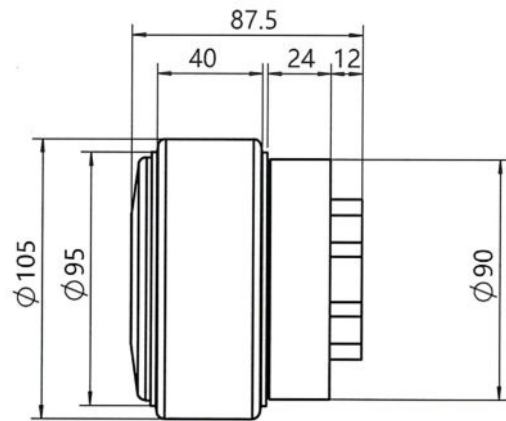

Basic Information	
Wheel Diameter(mm)	120
Wheel Hub Diameter(mm)	95
Wheel Material	Polyurethane      Rubber
Load Capacity(kg)	400                  350
Rated Voltage(V)	48
Flange Type	Round flange
Maintenance Method	Refer to maintenance manual
Maintenance Interval	Refer to maintenance manual

Drive Unit	
Motor Model	SMC60S/0040/30MAK/5DSU
Rated Power(W)	400
Rated Speed(rpm)	3000
Rated Torque(N·m)	1.27
Rated Current(A)	10.6
Built/in Encoder Type	Incremental magnetic Encoder
Encoder Performance	/

Gearbox Unit								
Gear Ratio	16	20	25	28	35	40	50	70
Gearbox Torque(N·m)	30	33	33	33	33	33	33	21.5
Max. Speed(m/min)	70.7	56.5	45.2	40.4	32.3	28.3	22.6	16.1
Traction Force(N)	304.8	381	476.3	495	495	495	495	322.5
Towing Capacity(kg)	579.1	723.9	904.9	940.5	940.5	940.5	940.5	612.7

\* Wheel material: Polyurethane (PU) standard, Rubber (RB) optional



**AB-DW-D120-P0.4-C400-R**

**NO. 11**

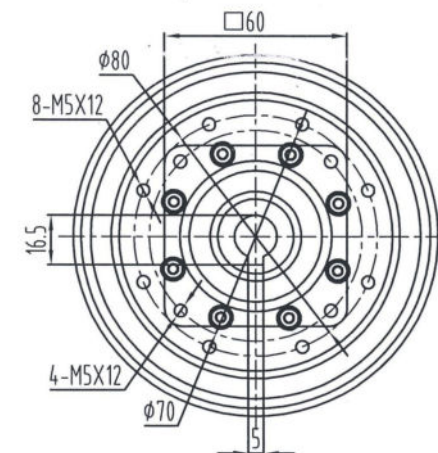
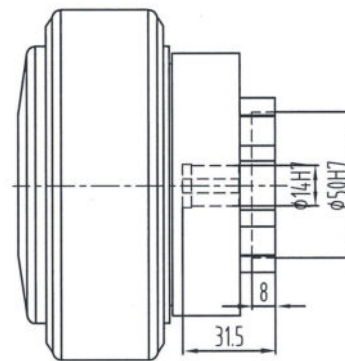
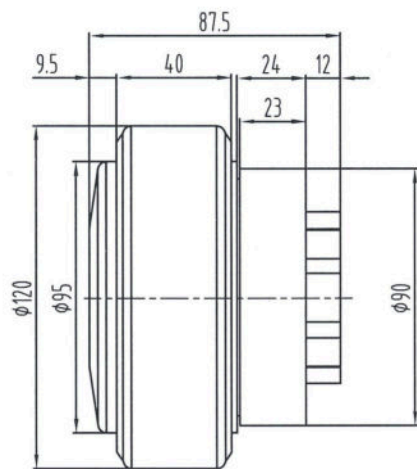

Basic Information	
Wheel Diameter(mm)	140
Wheel Hub Diameter(mm)	95
Wheel Material	Polyurethane      Rubber
Load Capacity(kg)	300      /
Rated Voltage(V)	48
Flange Type	Round flange
Maintenance Method	Refer to maintenance manual
Maintenance Interval	Refer to maintenance manual

Drive Unit	
Motor Model	SMC60S/0040/30MAK/5DSU
Rated Power(W)	400
Rated Speed(rpm)	3000
Rated Torque(N·m)	1.27
Rated Current(A)	10.6
Built/in Encoder Type	Incremental magnetic Encoder
Encoder Performance	/

Gearbox Unit								
Gear Ratio	16	20	25	28	35	40	50	70
Gearbox Torque(N·m)	30	30	33	30	33	30	33	21.5
Max. Speed(m/min)	82.4	65.9	52.8	47.1	37.7	33	26.4	18.8
Traction Force(N)	261.3	326.6	408.2	385.7	424.3	385.7	424.3	276.4
Towing Capacity(kg)	496.4	620.5	775.6	732.9	806.1	732.9	806.1	525.2

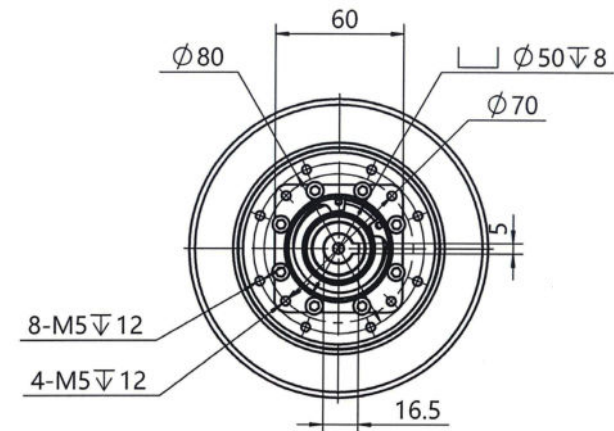
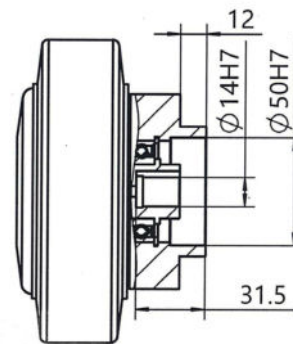
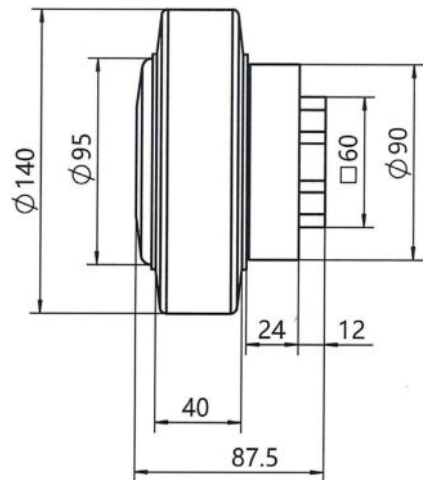

Basic Information	
Wheel Diameter(mm)	150
Wheel Hub Diameter(mm)	125
Wheel Material	Polyurethane      Rubber
Load Capacity(kg)	300      /
Rated Voltage(V)	48
Flange Type	Round flange
Maintenance Method	Refer to maintenance manual
Maintenance Interval	Refer to maintenance manual

Drive Unit	
Motor Model	SMC60S/0040/30MAK/5DSU
Rated Power(W)	400
Rated Speed(rpm)	3000
Rated Torque(N·m)	1.27
Rated Current(A)	11.95
Built/in Encoder Type	Incremental magnetic Encoder
Encoder Performance	/

Gearbox Unit								
Gear Ratio	16	20	25	28	35	40	50	70
Gearbox Torque(N·m)	30	30	33	30	33	30	33	21.5
Max. Speed(m/min)	88.3	70.7	56.5	50.5	40.4	35.3	28.3	20.2
Traction Force(N)	243.8	304.8	381	360	396	360	396	258
Towing Capacity(kg)	463.3	579.1	723.9	684	752.4	684	752.4	490.2



**AB-DW-D150-P0.4-C300-R**

**NO. 13**

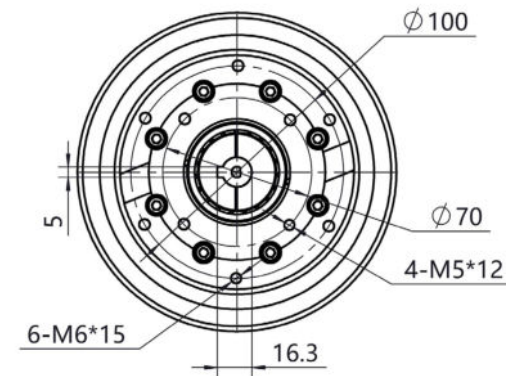
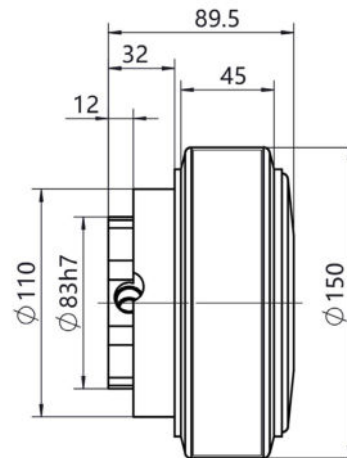
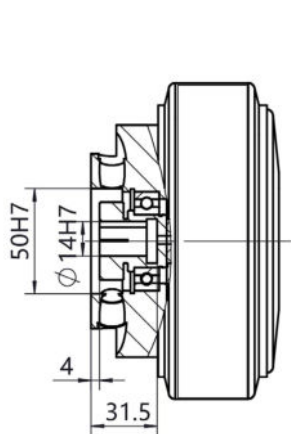

Basic Information	
Wheel Diameter(mm)	160
Wheel Hub Diameter(mm)	125
Wheel Material	Polyurethane      Rubber
Load Capacity(kg)	300                      250
Rated Voltage(V)	48
Flange Type	Round flange
Maintenance Method	Refer to maintenance manual
Maintenance Interval	Refer to maintenance manual

Drive Unit	
Motor Model	SMC60S/0040/30MAK/5DSU
Rated Power(W)	400
Rated Speed(rpm)	3000
Rated Torque(N·m)	1.27
Rated Current(A)	11.95
Built/in Encoder Type	Incremental magnetic Encoder
Encoder Performance	/

Gearbox Unit								
Gear Ratio	16	20	25	28	35	40	50	70
Gearbox Torque(N·m)	30	30	33	30	33	30	33	21.5
Max. Speed(m/min)	94.2	75.4	60.3	53.8	43.1	37.7	30.1	21.5
Traction Force(N)	228.6	285.8	357.2	337.5	371.3	337.5	371.3	241.9
Towing Capacity(kg)	434.3	542.9	678.7	641.3	705.4	641.3	705.4	459.6

\* Wheel material: Polyurethane (PU) standard, Rubber (RB) optional

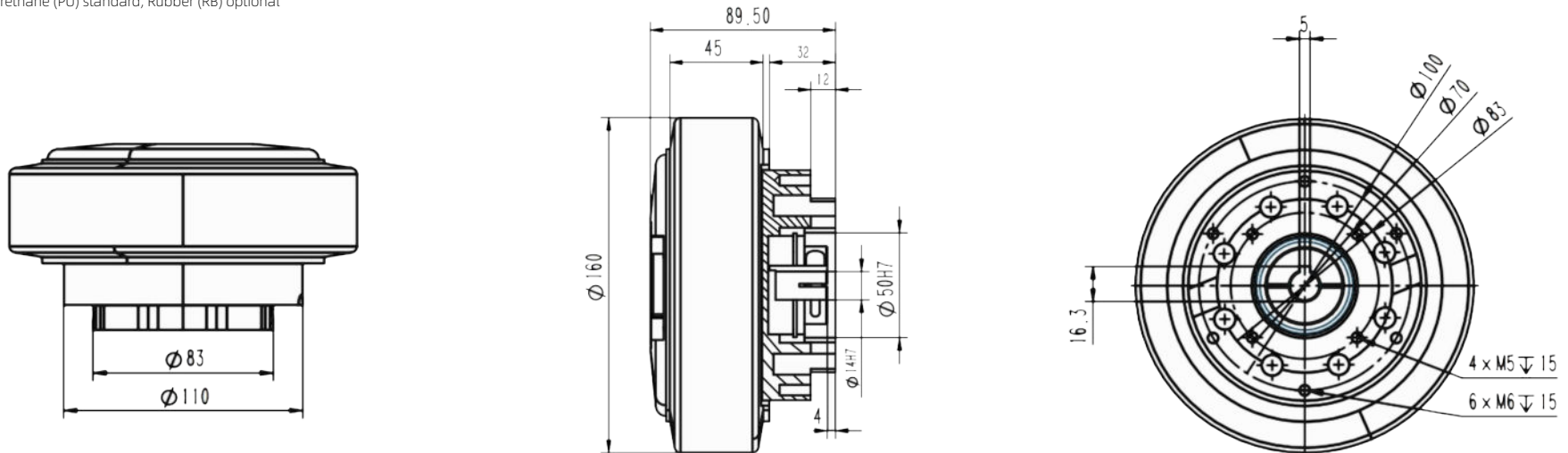

Basic Information	
Wheel Diameter(mm)	180
Wheel Hub Diameter(mm)	150
Wheel Material	Polyurethane      Rubber
Load Capacity(kg)	400      /
Rated Voltage(V)	48
Flange Type	Round flange
Maintenance Method	Refer to maintenance manual
Maintenance Interval	Refer to maintenance manual

Drive Unit	
Motor Model	SMC80S/0075/30MAK/5DSU
Rated Power(W)	750
Rated Speed(rpm)	3000
Rated Torque(N·m)	2.39
Rated Current(A)	19.9
Built/in Encoder Type	Incremental magnetic Encoder
Encoder Performance	/

Gearbox Unit								
Gear Ratio	16	20	25	28	35	40	50	70
Gearbox Torque(N·m)	96	96	105	96	105	96	105	71.5
Max. Speed(m/min)	106	84.8	67.8	60.6	48.4	42.4	33.9	24.2
Traction Force(N)	382.4	478	597.5	669.2	836.5	956	1050	715
Towing Capacity(kg)	726.6	908.2	1135.3	1271.5	1589.4	1816.4	1995	1358.5



**AB-DW-D180-P0.75-C400-R**

**NO. 15**

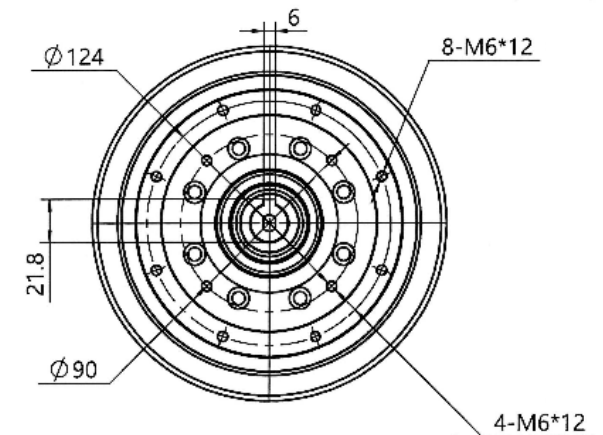
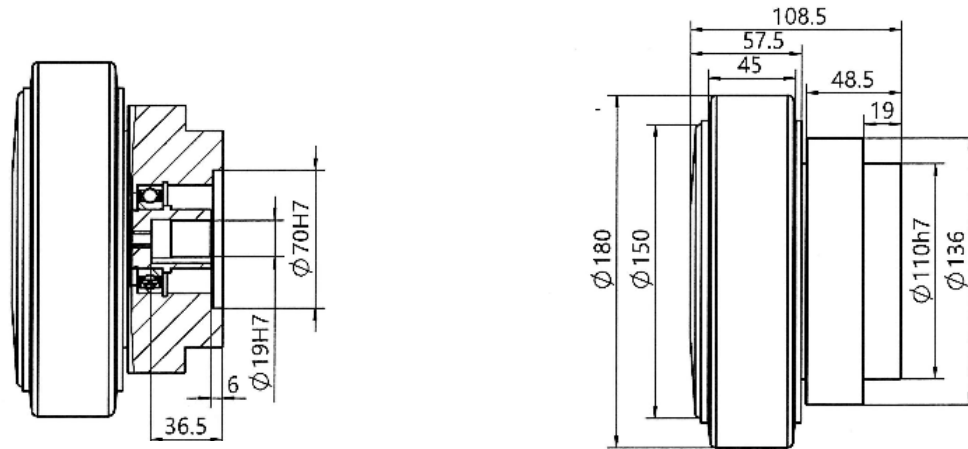

Basic Information	
Wheel Diameter(mm)	200
Wheel Hub Diameter(mm)	150
Wheel Material	Polyurethane      Rubber
Load Capacity(kg)	450                      350
Rated Voltage(V)	48
Flange Type	Round flange
Maintenance Method	Refer to maintenance manual
Maintenance Interval	Refer to maintenance manual

Drive Unit	
Motor Model	SMC80S/0100/30MAK/5DSU
Rated Power(W)	1000
Rated Speed(rpm)	3000
Rated Torque(N·m)	3.18
Rated Current(A)	26.4
Built/in Encoder Type	Incremental magnetic Encoder
Encoder Performance	/

Gearbox Unit								
Gear Ratio	16	20	25	28	35	40	50	70
Gearbox Torque(N·m)	96	96	105	96	105	96	105	71.5
Max. Speed(m/min)	117.8	94.2	75.4	67.3	53.8	47.1	37.7	26.9
Traction Force(N)	457.9	572.4	715.5	801.4	945	864	945	643.5
Towing Capacity(kg)	870	1087.6	1359.5	1522.6	1795.5	1641.4	1795.5	1222.7

\* Wheel material: Polyurethane (PU) standard, Rubber (RB) optional

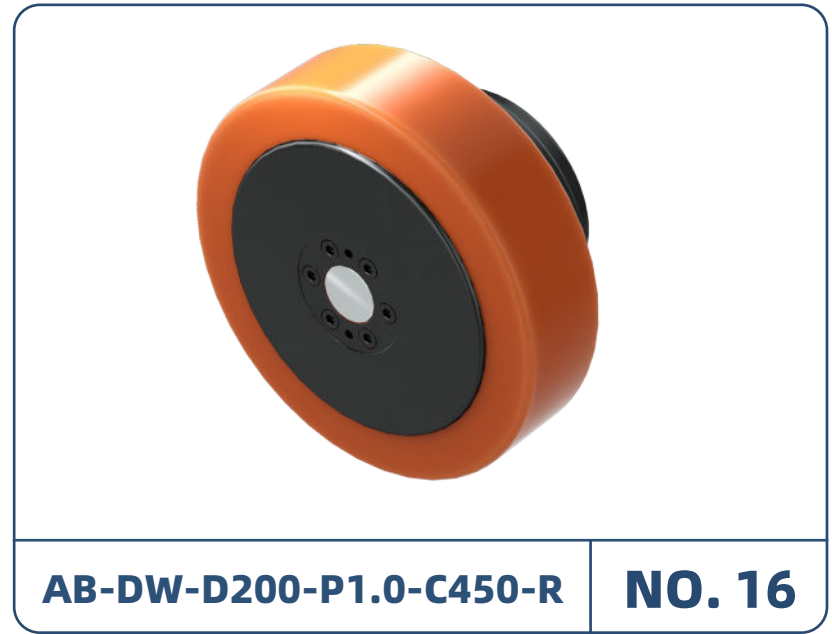

**AB-DW-D200-P1.0-C450-R**

**NO. 16**

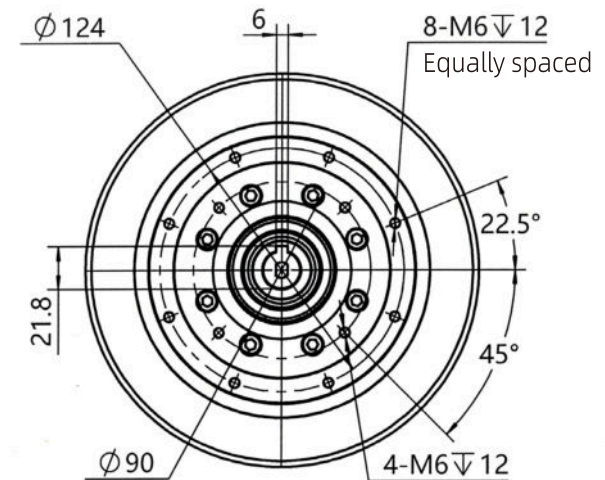
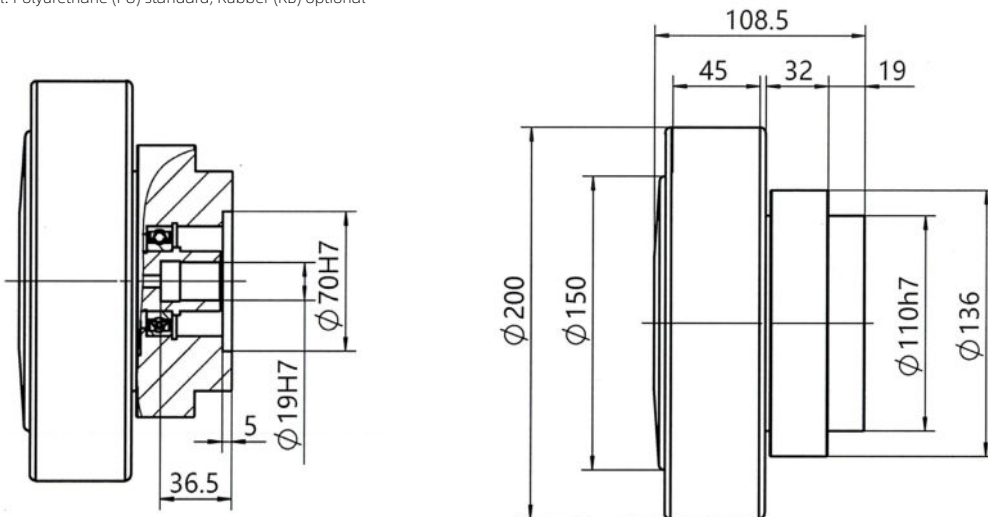

Basic Information	
Wheel Diameter(mm)	250
Wheel Hub Diameter(mm)	165
Wheel Material	Polyurethane      Rubber
Load Capacity(kg)	1120      750
Rated Voltage(V)	48
Flange Type	Round flange
Maintenance Method	Refer to maintenance manual
Maintenance Interval	Refer to maintenance manual

Drive Unit	
Motor Model	SMC80S/0075/30MAK/5DSU
Rated Power(W)	750
Rated Speed(rpm)	3000
Rated Torque(N·m)	2.39
Rated Current(A)	19.9
Built/in Encoder Type	Incremental magnetic Encoder
Encoder Performance	/

Gearbox Unit								
Gear Ratio	16	20	25	28	35	40	50	70
Gearbox Torque(N·m)	250	250	264	250	264	250	264	177
Max. Speed(m/min)	147.2	117.8	94.2	84.1	67.3	58.9	47.1	33.6
Traction Force(N)	270	340	430	480	600	680	860	1200
Towing Capacity(kg)	520	650	810	910	1140	1300	1630	2288.6

\* Wheel material: Polyurethane (PU) standard, Rubber (RB) optional

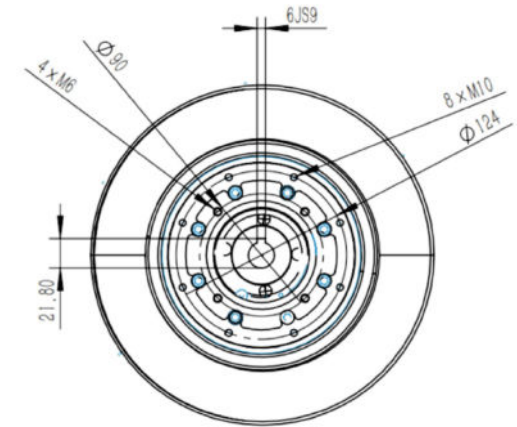
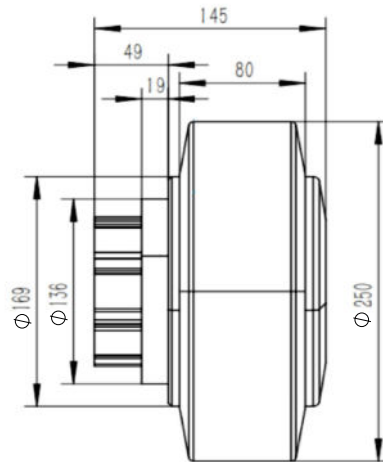
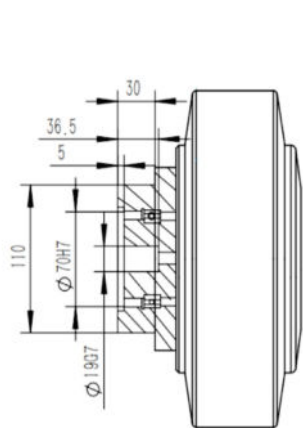

Basic Information	
Wheel Diameter(mm)	250
Wheel Hub Diameter(mm)	165
Wheel Material	Polyurethane      Rubber
Load Capacity(kg)	1150      /
Rated Voltage(V)	48
Flange Type	Round flange
Maintenance Method	Refer to maintenance manual
Maintenance Interval	Refer to maintenance manual

Drive Unit	
Motor Model	SMC130S/0150/30MAK/5DSU
Rated Power(W)	1500
Rated Speed(rpm)	3000
Rated Torque(N·m)	4.77
Rated Current(A)	39
Built/in Encoder Type	Incremental magnetic Encoder
Encoder Performance	/

Gearbox Unit								
Gear Ratio	16	20	25	28	35	40	50	70
Gearbox Torque(N·m)	250	250	264	250	264	250	264	177
Max. Speed(m/min)	147.2	117.8	94.2	84.1	67.3	58.9	47.1	33.6
Traction Force(N)	549.5	686.9	858.6	961.6	1202	1373.8	1717.2	1274.4
Towing Capacity(kg)	1044.1	1305.1	1631.3	1827.1	2283.9	2610.1	3262.7	2421.4

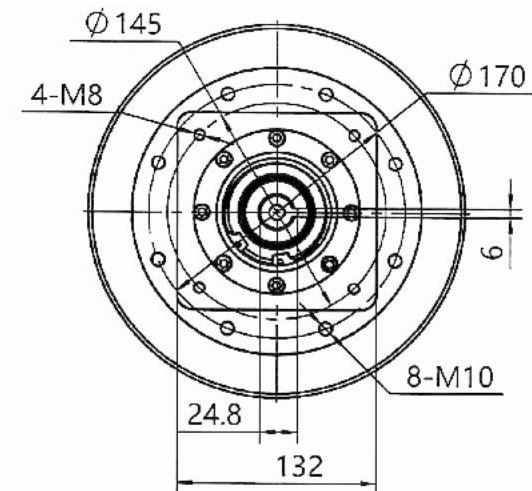
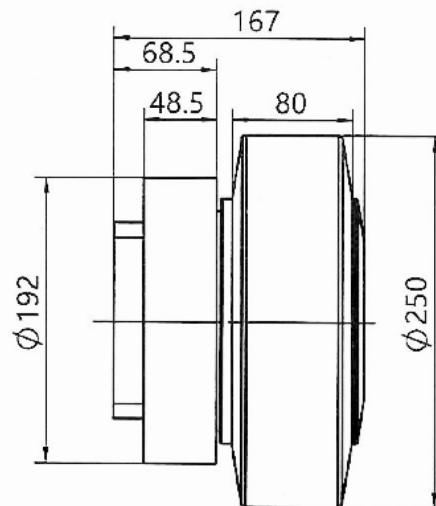
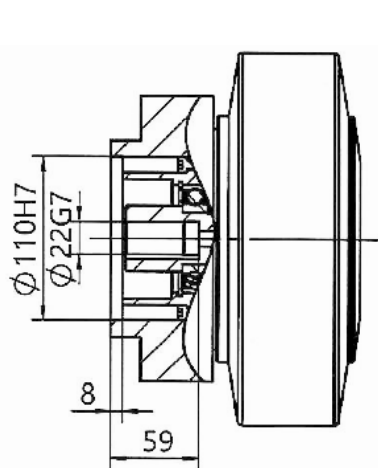

Basic Information	
Wheel Diameter(mm)	300
Wheel Hub Diameter(mm)	150
Wheel Material	Polyurethane      Rubber
Load Capacity(kg)	450      /
Rated Voltage(V)	48
Flange Type	Round flange
Maintenance Method	Refer to maintenance manual
Maintenance Interval	Refer to maintenance manual

Drive Unit	
Motor Model	SMC80S/0100/30MAK/5DSU
Rated Power(W)	1000
Rated Speed(rpm)	3000
Rated Torque(N·m)	3.18
Rated Current(A)	/
Built/in Encoder Type	Incremental magnetic Encoder
Encoder Performance	/

Gearbox Unit								
Gear Ratio	16	20	25	28	35	40	50	70
Gearbox Torque(N·m)	96	96	105	96	105	96	105	71.5
Max. Speed(m/min)	176.6	141.3	113	100.9	80.7	70.7	56.5	40.4
Traction Force(N)	307.2	384	480	537.6	630	576	630	429
Towing Capacity(kg)	583.7	729.6	912	1021.4	1197	1094.4	1197	815.1



**AB-DW-D300-P1.0-C450-R      NO. 19**

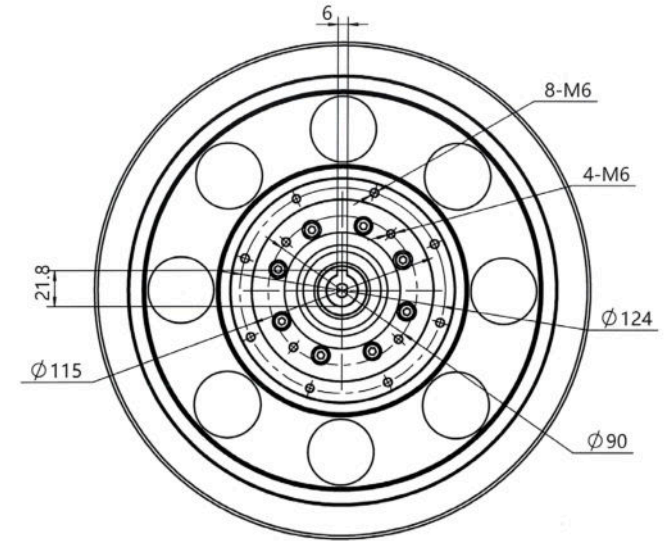
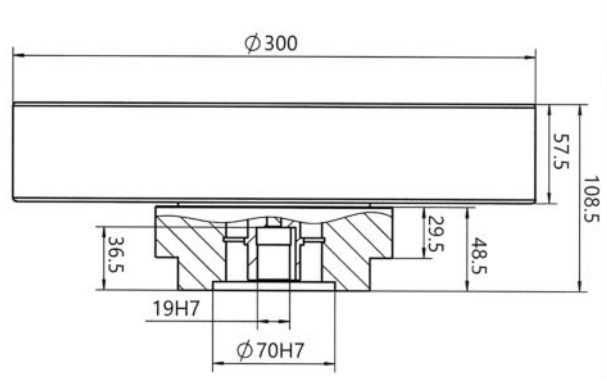



Basic Information	
Wheel Diameter(mm)	380
Wheel Hub Diameter(mm)	200
Wheel Material	Polyurethane      Rubber
Load Capacity(kg)	1120      /
Rated Voltage(V)	48
Flange Type	Round flange
Maintenance Method	Refer to maintenance manual
Maintenance Interval	Refer to maintenance manual

Drive Unit	
Motor Model	/
Rated Power(W)	4000
Rated Speed(rpm)	2000
Rated Torque(N·m)	19
Rated Current(A)	96
Built/in Encoder Type	Incremental magnetic Encoder
Encoder Performance	/

Gearbox Unit								
Gear Ratio	16	20	25	28	35	40	50	70
Gearbox Torque(N·m)	250	250	264	250	264	250	264	177
Max. Speed(m/min)	149	119	95	85	68	60	48	34
Traction Force(N)	1180	1180	1240	1180	1240	1180	1240	830
Towing Capacity(kg)	2200	2200	2300	2200	2300	2200	2300	1530



**AB-DW-D380-P4.0-C1120-R**

**NO. 20**

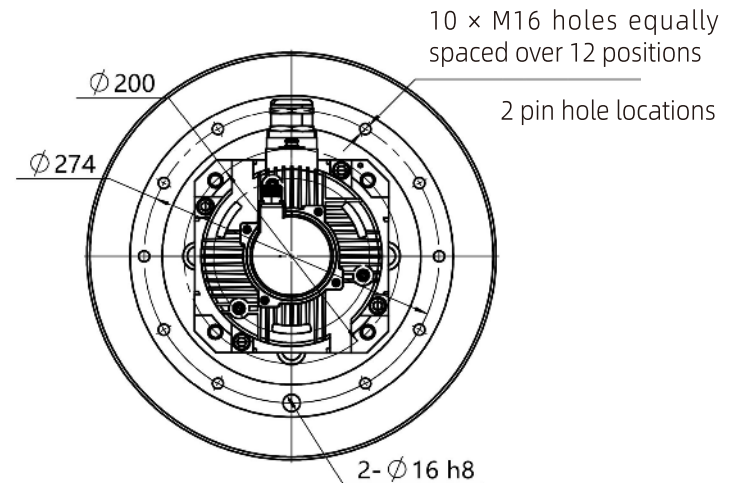
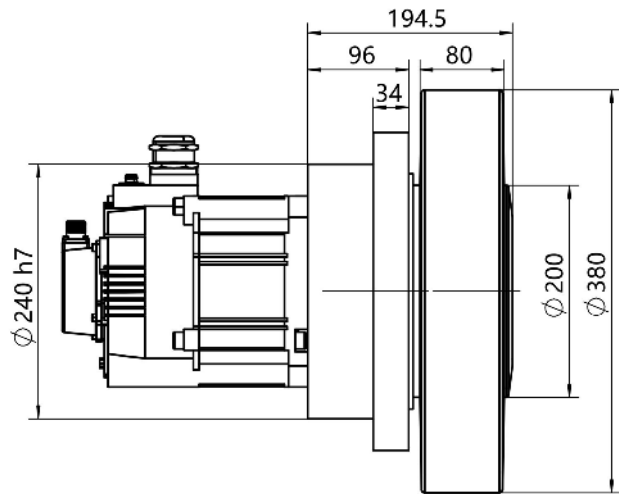

contact@atombotix.com

www.atombotix.com

Basic Information		Drive Unit	
Wheel Diameter(mm)	380	Motor Model	/
Wheel Hub Diameter(mm)	300	Rated Power(W)	5000
Wheel Material	Polyurethane      Rubber	Rated Speed(rpm)	3000
Load Capacity(kg)	2500      /	Rated Torque(N·m)	16
Rated Voltage(V)	48	Rated Current(A)	127±12.7
Flange Type	Round flange	Built/in Encoder Type	Incremental magnetic Encoder
Maintenance Method	Refer to maintenance manual	Encoder Performance	/
Maintenance Interval	Refer to maintenance manual		

Gearbox Unit								
Gear Ratio	16	20	25	28	35	40	50	70
Gearbox Torque(N·m)	1300	1300	1100	1300	1100	1300	1100	800
Max. Speed(m/min)	223.7	179	143.2	127.8	102.3	89.5	71.6	51.1
Traction Force(N)	1212.6	1515.8	1894.7	2122.1	2652.6	3031.6	3789.5	3789.5
Towing Capacity(kg)	2304	2880	3600	4032	5040	5760	7200	7200

**AB-DW-D380-P5.0-C2500-R**
**NO. 21**
